



## Yuasa Fiche de données techniques

### Yuasa YB10L-BP - YuMicron Batterie

#### Performance

Tension	12V
Capacité (10heures)	12Ah
Capacité (20 heures)	12.6Ah
CCA à -18°C	165A

#### Dimensions (±2mm)

Longueur	135mm
Largeur	90mm
Hauteur	145mm

#### Poids & Mesures

Poids moyen avec acide	4kg
Volume d'acide	0.8l

#### Technologie

Technologie	Moulé Sb/Sb
Séparateur	Leaf

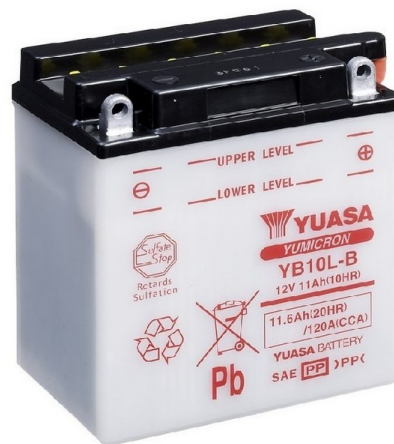

#### Schéma de montage des éléments

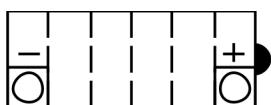

#### Type de bornes - 6

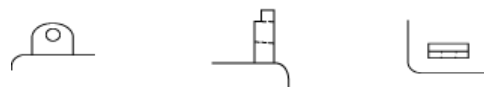

Date de publication: 10/01/2022 - E&OE



## Yuasa Technical Data Sheet

### Yuasa YB10L-BP - YuMicron Battery

#### Performance

Voltage	12V
Capacity (10-hour)	12Ah
Capacity (20-hour)	12.6Ah
CCA @ -18°C	165A

#### Dimensions (±2mm)

Length	135mm
Width	90mm
Height	145mm

#### Weights & Measures

Mean Weight with Acid	4kg
Acid Volume	0.8l

#### Technology

Technology	Cast Sb/Sb
Separator	Leaf

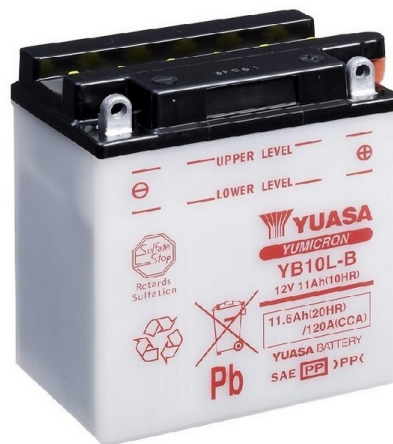

#### Cell Assembly Layout

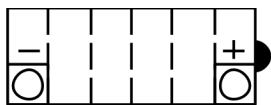

#### Terminal Type - 6

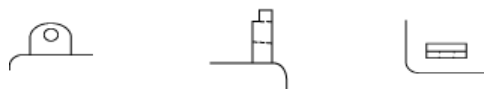

Data Sheet generated on 10/01/2022 - E&OE